

 **EVERFLOW™**

SAMMYS®
PRODUCT CATALOG

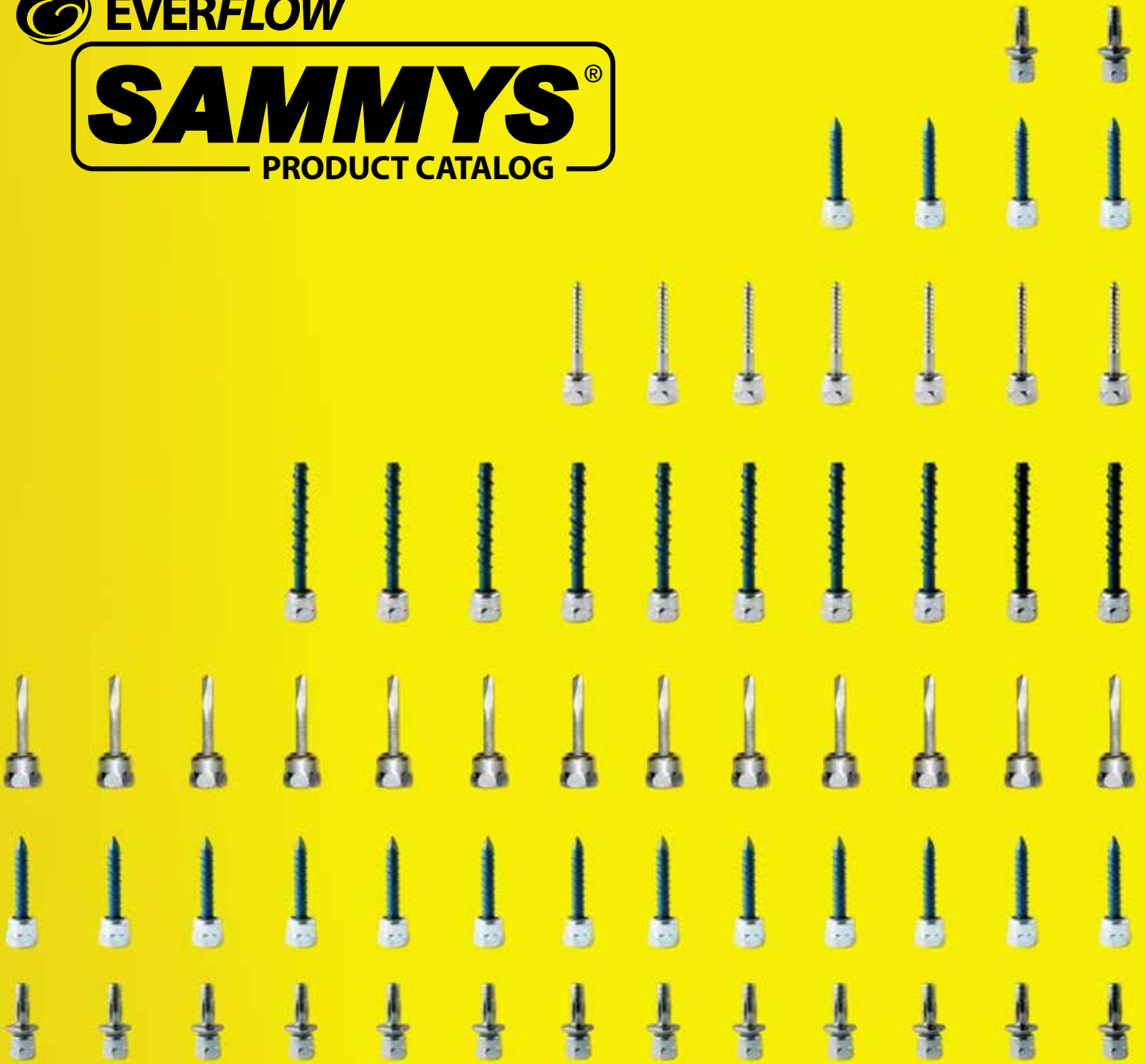

Go with the *FLOW*

877.941.7800 | everflowsupplies.com

TABLE OF CONTENTS

| | |
|------------------------------------|----|
| Approvals and Listings | 3 |
| Sammys for Wood | 4 |
| Sidewinder for Wood | 5 |
| Sammys Swivel Head for Wood | 5 |
| Sammys for Steel | 6 |
| Sidewinder for Steel | 7 |
| Sammys Swivel Head for Steel | 7 |
| Sammy X-Press for Steel | 8 |
| Sammy X-Press Sidewinder for Steel | 8 |
| Sammy X-Press Swivel For Steel | 9 |
| Sammy X-Press It | 9 |
| Sammys for Concrete | 10 |
| Sidewinder for Concrete | 10 |
| Sammys Swivel Head for Concrete | 11 |
| Concrete / Wood Installation Kit | 11 |
| Sammys Toggle | 12 |
| Ceiling Screws | 12 |
| Dektite Pipe Flashing | 13 |
| Speedy Pole Tool | 13 |
| Installation Instructions | 14 |
| Special Notes | 15 |

Warranty • Disclaimer of Warranty

Proper fastener connection design takes into account where and how fasteners are used. Allowance for special characteristics in materials, differences in materials, differences in types of materials being joined, unique or unusual environmental service or installation conditions and the safety factors required by anticipating normal or short term loading conditions must be considered. Due to possible differences in specifications, applications and interpretation of results, purchasers and specifiers must make their own evaluation of the products, to determine the suitability of these products for intended use. All warranties of Buildex products, expressed or implied, including the warranties of merchantability and fitness for particular purposes are specifically excluded except for the following: Buildex will repair or replace any product which, within twelve months after sale by Buildex or its distributors, is found by Buildex to be defective in material or workmanship - normal wear and tear accepted. This is the sole warranty of Buildex and the sole remedy available to distributor or buyer. Buildex shall not be liable for any injury, loss or damage, direct, indirect, or consequential, arising out of the use of, or the inability to use, any Buildex product.

| Part # | Model | Rod Size | Mount Direction | UL Max Pipe Size | UL Test Load (lbs) | UL Min Wood Thickness | FM Max Pipe Size | FM Test Load (lbs) | FM Min Wood Thickness |
|--|---------------|----------|------------------------------------|----------------------|------------------------|---|------------------|--------------------|-----------------------|
| SAMMYS FOR WOOD - PIPE HANGER | | | | | | | | | |
| 8007957 | GST 10 | 3/8" | Vertical | CPVC 1-1/2" | 300 | 1-1/2" | - | - | - |
| 8020957 | SWG 10 | 3/8" | Horizontal | CPVC 1-1/2" | 300 | 1-1/2" | - | - | - |
| 8008957 | GST 20 | 3/8" | Vertical | 2-1/2" | 850 | 1-1/2" | 4" | 1475 | 1-1/2" |
| 8068925 | GST 20-SS | 3/8" | Vertical | 2-1/2" | 850 | 1-1/2" | - | - | - |
| 8010957 | GST 30 | 3/8" | Vertical | 4" | 1500 | 1-1/2" | 4" | 1475 | 1-1/2" |
| 8009925 | GST 25-380 | 3/8" | Vertical | 4" | 1500 | 1-1/2" | - | - | - |
| 8022925 | SWG 25-380 | 3/8" | Horizontal | 3-1/2" - 4" | 1500 | 1-1/2" | - | - | - |
| 8021957 | SWG 20 | 3/8" | Horizontal | 2-1/2" - 3" | 1050 | 1-1/2" | - | - | - |
| 8073925 | SWG 20-SS | 3/8" | Horizontal | 2-1/2" | 850 | 1-1/2" | - | - | - |
| 8269957 | SH-GST/CST 20 | 3/8" | 45° Angle off Vertical | 2-1/2" | 850 | 1-1/2" | - | - | - |
| 8269957 | SH-GST/CST 20 | 3/8" | 45° Angle off Vertical | 4" | 1500 | 1-1/2" | - | - | - |
| 8139957 | SH-GST 20 | 3/8" | 17° Angle off Vertical | 3" | 1050 | 1-1/2" | 4" | 1475 | 1-1/2" |
| SAMMYS FOR STEEL - PIPE HANGER | | | | | | Min Steel Thick | Max Steel | | |
| 8038957 | DSTR 1 | 3/8" | Vertical | 4" | 1500 | .035" | 4" | 1475 | .105" |
| 8037957 | DSTR 1-1/2 | 3/8" | Vertical | 4" | 1500 | .035" | 4" | 1475 | .105" |
| 8039957 | DSTR 516 | 3/8" | Vertical | 4" | 1500 | .037" | 4" | 1475 | .105" |
| 8045957 | DST 516 | 3/8" | Vertical | 4" | 1500 | .188" | 4" | 1475 | .188" |
| 8046957 | TEK 50 | 3/8" | Vertical | 4" | 1500 | .250" | 4" | 1475 | .188" |
| 8055957 | SWDR 1 | 3/8" | Horizontal | 4" | 1500 | .037" | 4" | 1475 | .060" |
| 8056957 | SWDR 516 | 3/8" | Horizontal | 4" | 1500 | .037" | 4" | 1475 | .060" |
| 8054957 | SWDR 1-1/2 | 3/8" | Horizontal | 4" | 1500 | .037" | 4" | 1475 | .060" |
| 8137957 | SH-DSTR 1 | 3/8" | 17° Angle off Vertical | 4" | 1500 | .035" | 4" | 1475 | .105" |
| 8268957 | SH-TEK 50 | 3/8" | Vertical 70° Angle off Vertical | 4" 2-1/2" | 850 1500 | - | - | - | - |
| 8150922 | XP 20 | 3/8" | Vertical | 2-1/2" | 850 | .027" | 2" 4" | 940 1475 | .029" .105" |
| 8153922 | XP 35 | 3/8" | Vertical | 4" | 1500 | .060" | 2" 4" | 940 1475 | .029" .105" |
| 8294922 | | 3/8" | Vertical or up to 45° | 2" | 750 | .027" | 2" | 635 | .029" |
| 8295922 | SXP 35 | 3/8" | Vertical or up to 89° | 3-1/2" | 1250 | .060" | 2" | 635 | .029" |
| 8293957 | SWXP 35 | 3/8" | Horizontal | 3-1/2" | 1250 | .060" | - | - | - |
| SAMMYS FOR CONCRETE - PIPE HANGER | | | | | | | | | |
| 8059957 | CST 20 | 3/8" | Vertical | - | - | - | 4" | 1475 | 3000 |
| 8061957 | SWC 20 | 3/8" | Horizontal | - | - | - | 4" | 1475 | 3000 |
| 8150922 | XP 20 | 3/8" | Vertical | 2-1/2" | 850 | Pre-Pour Structural @ 3000psi | | | |
| 8150922 | XP 20 | 3/8" | Vertical | 2-1/2" | 850 | Post-Pour Range II LWC ≤ 35 PCF (lbs/ft³) | | | |
| Part # | Model | Rod Size | Mount Direction | UL Load Rating (lbs) | UL Min Steel Thickness | | | | |
| SAMMYS FOR STEEL - LUMINAIRE FITTINGS | | | | | | | | | |
| 8150922 | XP 20 | 3/8" | Vertical | 185 250 | .027" .035" | | | | |
| 8153922 | XP 35 | 3/8" | Vertical | 185 250 | .027" .035" | | | | |
| 8181922 | XP 200 | 1/4" | Vertical | 185 250 | .027" .035" | | | | |
| 8294922 | SXP 20 | 3/8" | Vertical 45° | 170 80 | .027" .027" | | | | |
| 8295922 | SXP 35 | 3/8" | Vertical 90° | 250 80 | .060" .060" | | | | |
| 8293957 | SWXP 35 | 3/8" | Horizontal | 80 | .060" | | | | |
| Part # | Model | Rod Size | Mount Direction | UL Load Rating | UL Min Steel Thickness | Listed Application | | | |
| SAMMYS FOR STEEL - CONDUIT, TUBING, AND CABLE | | | | | | | | | |
| 8150922 | XP 20 | 3/8" | Vertical | 185 250 | .027" .035" | Max 4 trade size EMT, RMC, and IMC & 5 trade size rigid PVC conduit | | | |
| 8153922 | XP 35 | 3/8" | Vertical | 185 250 | .027" .035" | Max 4 trade size EMT & 6 trade size RMC, IMC, and rigid PVC conduit | | | |
| 8181922 | XP 200 | 1/4" | Vertical | 185 250 | .027" .035" | Max 4 trade size EMT, RMC, and IMC & 5 trade size rigid PVC conduit | | | |
| 8294922 | SXP 20 | 3/8" | Vertical 45° | 170 80 | .027" .027" | Max 4 trade size EMT & 6 trade size RMC, IMC, and rigid PVC conduit | | | |
| 8295922 | SXP 35 | 3/8" | Vertical 90° | 250 80 | .060" .060" | Max 4 trade size EMT & 6 trade size RMC, IMC, and rigid PVC conduit | | | |
| 8293957 | SWXP 35 | 3/8" | Horizontal | 80 | .060" | UL Listed 4S16 - Cable Hanger, Cat. No. C-Z2000 Plenum Rated, Complies w/ NEC Standards | | | |
| Sheet Steel Gauges | | | | | | | | | |
| Gauge No. | 22 ga. | 20 ga. | 18 ga. | 16 ga. | 14 ga. | 12 ga. | 1/8" | 3/16" | 1/4" |
| Nominal Decimal Equivalent | .030" | .036" | .048" | .060" | .075" | .105" | .125" | .188" | .250" |

*SWG 25-380 Maximum pipe size in composite wood joist allowed by UL is 3-1/2"
 *SWG 25-380 Maximum pipe size in wood timber or joist allowed by UL is 4"
 **SWG 20 Maximum pipe size in composite wood joist allowed by UL is 2-1/2"
 **SWG 20 Maximum pipe size in wood timber or joist allowed by UL is 3"

UL compliance with NEC Standards.
 UL and FM tests were performed in compliance with NFPA 13 Standards.
 Fastening requirement: 5 times weight of water-filled schedule 40 pipe plus 250 pounds.

SAMMYS® FOR WOOD

VERTICAL APPLICATION



Product Features

- No pre-drilling required.
- Quick to install using the Sammy Nut Driver with an 18V cordless drill/driver.
- Saves time from traditional methods.
- Reduces installation costs.
- Manufactured in the U.S.A.

Watch a video demonstration at www.itwbuildex.com

Application

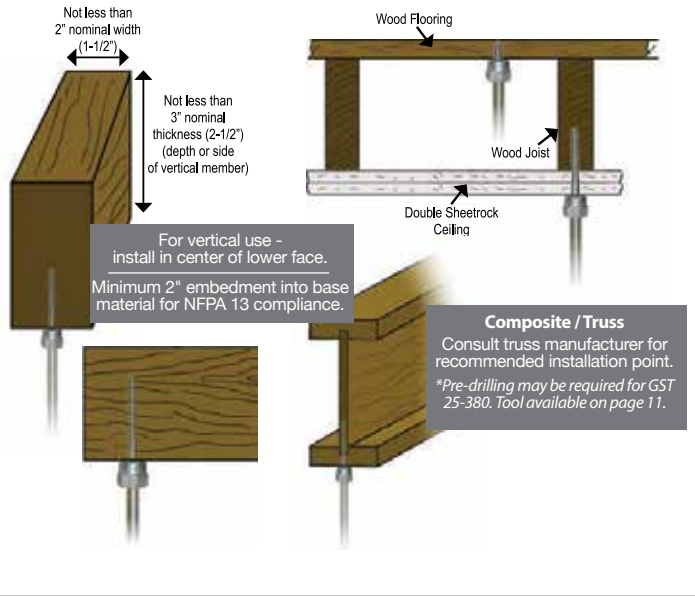

| Bit | Approvals | Rod Size | Part # | Model | Screw Descriptions | Ultimate Pullout (lbs) | UL Test Load (lbs) | FM Test Load (lbs) | Box Qty | Case Qty |
|-------|-----------|----------|---------|------------|--------------------|-----------------------------------|--------------------|--------------------|---------|----------|
| - | - | 1/4" | 8002957 | GST 100 | 1/4 x 1" | 210 (7/16" OSB) 670 (3/4" Ply) | - | - | 25 | 125 |
| - | - | 1/4" | 8003957 | GST 200 | 1/4 x 2" | 1760 (Fir) | - | - | 25 | 125 |
| UL | - | 3/8" | 8007957 | GST 10 | 1/4 x 1" | 210 (7/16" OSB) 670 (3/4" Ply) | 300 | - | 25 | 125 |
| UL FM | - | 3/8" | 8008957 | GST 20 | 1/4 x 2" | 1760 (Fir) | 850 | 1475 | 25 | 125 |
| UL | - | 3/8" | 8068925 | GST 20-SS | 1/4 x 2" | 1760 (Fir) | 850 | - | 25 | 125 |
| UL | - | 3/8" | 8009925 | GST 25-380 | 3/8 x 2-1/2" | 2113 (Fir) | 1500 | - | 25 | 125 |
| UL FM | - | 3/8" | 8010957 | GST 30 | 1/4 x 3" | 2060 (Fir) | 1500 | 1475 | 25 | 125 |
| - | - | 3/8" | 8069925 | GST 30-SS | 1/4 x 3" | 2060 (Fir) | - | - | 25 | 125 |
| - | - | 1/2" | 8013925 | GST 2 | 1/4 x 2" | 1760 (Fir) | - | - | 25 | 125 |
| - | - | 1/2" | 8015925 | GST 3 | 1/4 x 3" | 2275 (Fir) | - | - | 25 | 125 |



SPECIAL NUT DRIVER SYSTEM: The nut drivers were designed with a unique spin-off feature which provides a fast and safe installation each time. When the face of the driver comes into contact with the material you are installing into, continue drilling until nut driver spins free. Installation is then complete. Warranty requires the use of the appropriate nut driver for installations.

Nut Driver Key*

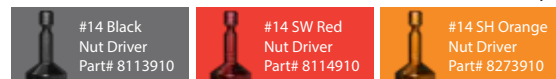

SIDEWINDER® FOR WOOD

HORIZONTAL APPLICATION



Product Features

- No pre-drilling required.
- Quick to install using the Sammy Nut Driver with an 18V cordless drill/driver.
- Saves time from traditional methods.
- Reduces installation costs.
- Manufactured in the U.S.A.

Watch a video demonstration at www.itwbuildex.com

Application

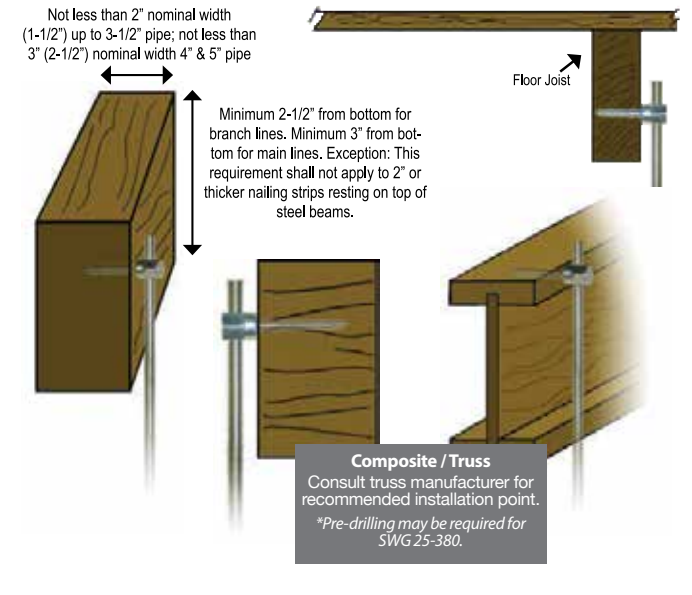

| Bit | Approvals | Rod Size | Part # | Model | Screw Descriptions | Ultimate Pullout (lbs) | UL Test Load (lbs) | Box Qty | Case Qty |
|-----|-----------|----------|---------|------------|--------------------|------------------------|--------------------|---------|----------|
| - | | 1/4" | 8019957 | SWG 200 | 1/4 x 2" | 1725 (Fir) | - | 25 | 125 |
| UL | | 3/8" | 8020957 | SWG 10 | 1/4 x 1" | 622 (Fir) | 300 | 25 | 125 |
| UL | | 3/8" | 8021957 | SWG 20 | 1/4 x 2" | 1725 (Fir) | 1050 | 25 | 125 |
| UL | | 3/8" | 8073925 | SWG 20-SS | 1/4 x 2" | 1725 (Fir) | 850 | 25 | 125 |
| UL | | 3/8" | 8022925 | SWG 25-380 | 3/8 x 2-1/2" | 2249 (Fir) | 1500 | 25 | 125 |
| - | | 3/8" | 8023925 | SWG 30 | 1/4" x 3" | 1884 (Fir) | - | 25 | 125 |

*May require pre-drilling; consult joist manufacturer.

SAMMYS SWIVEL HEAD™ FOR WOOD

SWIVEL APPLICATION



Product Features

- Eliminates distortion of threaded rod.
- Accommodates up to 3 1/2 x 12 pitch roof.
- Allows 17° deflection from vertical
- Saves time from traditional methods.
- Reduces installation costs.
- Manufactured in the U.S.A.

Application



| Bit | Approvals | Rod | Part # | Model | Screw Descriptions | Ultimate Pullout (lbs) | UL Test Load (lbs) | FM Test | Box Qty | Case Qty |
|-------|-----------|------|---------|----------------|--------------------|---|--------------------|---------|---------|----------|
| UL FM | | 3/8" | 8073925 | SH-GST 20 | 1/4 x 2" | 1257 (Fir) | 1050 | 1475 | 25 | 125 |
| UL | | 3/8" | 8022925 | SH-GST/CST 20 | 5/16 x 1-3/4" | 1903 Dim. Lumber 1406 at 45° off vertical Dim. Lumber | 1500 850 at 45° | - | 25 | 125 |
| - | | 3/8" | 8023925 | SH-GST/CST 2.0 | 5/16 x 1-3/4" | 903 Dim. Lumber 1406 at 45° off vertical Dim. Lumber | - | - | 25 | 125 |

*May require pre-drilling; consult joist manufacturer.

SAMMYS® FOR STEEL

VERTICAL APPLICATION



Product Features

- Made with Tek® self-drilling fasteners - no pre-drilling required.
- Installs into steel range from 20 gauge - 1/2" thicknesses.
- Saves time from traditional methods.
- Reduces installation costs.
- Quick to install using the Sammys Nut Driver with an 18V cordless drill/driver.
- A standard screwgun with a depth sensitive nosepiece should be used to install Tek®. For optimal fastener performance, the screwgun should be a minimum of 6 amps and have an RPM range of 0-2500.
- Manufactured in the U.S.A.

Watch a video demonstration at www.itwbuildex.com

Application

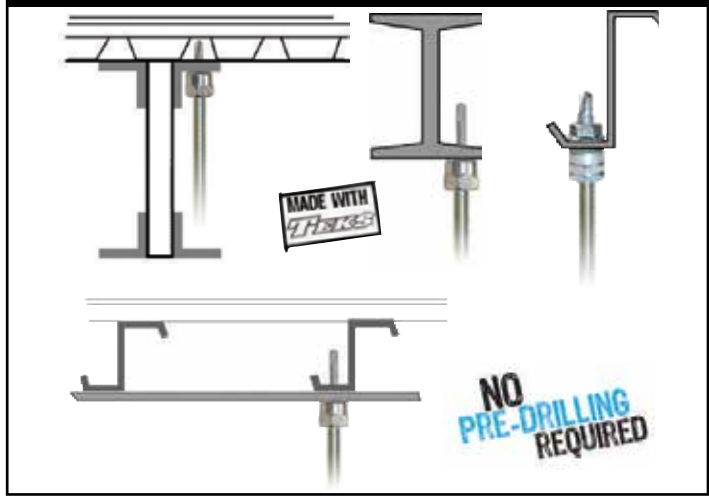

| Bit | Approvals | Rod Size | Part # | Model | Screw Descriptions | Ultimate Pullout (lbs) | UL Test Load (lbs) | FM Test Load (lbs) | Min Thick | Max Thick | Box Qty | Case Qty |
|-------|-----------|----------|---------|--------------|-------------------------|------------------------------|--------------------|--------------------|--------------|-----------|---------|----------|
| - | | 1/4" | 8024957 | DSTR 100 * | 1/4-20 x 1" TEKS 3 | 1510 (20 ga.) | - | - | .036"-20 ga | 3/16" | 25 | 125 |
| - | | 1/4" | 8025957 | DST 100 | 1/4-14 x 1" TEKS 3 | 446 (20 ga.) | - | - | .036"-20 ga | 3/16" | 25 | 125 |
| - | | 1/4" | 8026957 | DST 150 | 1/4-14 x 1-1/2" TEKS 3 | 970 (16 ga.) | - | - | .036"-20 ga | 3/16" | 25 | 125 |
| - | | 1/4" | 8027957 | DST 200 | 1/4-14 x 2" TEKS 3 | 446 (20 ga.) | - | - | .036"-20 ga | 3/16" | 25 | 125 |
| - | | 1/4" | 8030957 | TEK 500 | 12-24 x 1-1/2" TEKS 5 | 3125 (3/16") | - | - | .188"-3/16" | 1/2" | 25 | 125 |
| UL FM | | 3/8" | 8038957 | DSTR 1 * | 1/4-20 x 1" TEKS 3 | 1510 (20 ga.) | 1500 | 1475 | .036"-20 ga | 3/16" | 25 | 125 |
| UL FM | | 3/8" | 8037957 | DSTR 1-1/2 * | 12-24 x 1-1/2" TEKS 5 | 1510 (3/16") | 1500 | 1475 | .060"-16 ga. | 1/2" | 25 | 125 |
| UL FM | | 3/8" | 8039957 | DSTR 516 * | 5/16-18 x 1-1/4" TEKS 3 | 2200 (20 ga.) | 1500 | 1475 | .036"-20 ga | 3/16" | 25 | 125 |
| - | | 3/8" | 8040957 | DST 10 | 1/4-14 x 1" TEKS 3 | 446 (20 ga.) 970 (16 ga.) | - | - | .036"-20 ga | 3/16" | 25 | 125 |
| - | | 3/8" | 8077925 | DST 10-SS | 1/4-14 x 1" TEKS 3 | 446 (20 ga.) 970 (16 ga.) | - | - | .036"-20 ga | 3/16" | 25 | 125 |
| - | | 3/8" | 8041957 | DST 15 | 1/4-14 x 1-1/2" TEKS 3 | 446 (20 ga.) 970 (16 ga.) | - | - | .036"-20 ga | 3/16" | 25 | 125 |
| - | | 3/8" | 8078925 | DST 15-SS | 1/4-14 x 1-1/2" TEKS 3 | 446 (20 ga.) 970 (16 ga.) | - | - | .036"-20 ga | 3/16" | 25 | 125 |
| - | | 3/8" | 8042957 | DST 20 | 1/4-14 x 2" TEKS 3 | 446 (20 ga.) 970 (16 ga.) | - | - | .036"-20 ga | 3/16" | 25 | 125 |
| - | | 3/8" | 8044957 | DST 30 | 1/4-14 x 3" TEKS 3 | 446 (20 ga.) 970 (16 ga.) | - | - | .036"-20 ga | 3/16" | 25 | 125 |
| UL FM | | 3/8" | 8045957 | DST 516 | 5/16-18 x 1-1/4" TEKS 3 | 1500 (3/16") | 1500 | 1475 | .125"-1/8" | 3/16" | 25 | 125 |
| UL FM | | 3/8" | 8046957 | TEK 50 | 12-24 x 1-1/2" TEKS 5 | 3125 (3/16") | 1500 | 1475 | .250"-1/4" | 1/2" | 25 | 125 |
| - | | 1/2" | 8031925 | DST 2.0 | 1/4-14 x 2" TEKS 3 | 446 (20 ga.) 970 (16 ga.) | - | - | .188"-3/16" | 1/4" | 25 | 125 |
| - | | 1/2" | 8033925 | DSTR 1.0 * | 1/4-20 x 1" TEKS 3 | 1510 (20 ga.) | - | - | .036"-20 ga | 3/16" | 25 | 125 |
| - | | 1/2" | 8034925 | DSTR 5.16 * | 5/16-18 x 1-1/4" TEKS 3 | 2220 (20 ga.) | - | - | .036"-20 ga | 3/16" | 25 | 125 |
| - | | 1/2" | 8035925 | DST 5.16 | 5/16-18 x 1-1/4" TEKS 3 | 1500 (3/16") | - | - | .125"-1/8" | 3/16" | 25 | 125 |
| - | | 1/2" | 8036925 | TEK 5.0 | 12-24 x 1-1/2" TEKS 5 | 3125 (3/16") | - | - | .188"-3/16" | 1/2" | 25 | 125 |

*Includes retaining nut

Nut Driver Key*

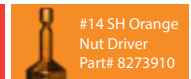
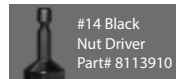

SPECIAL NUT DRIVER SYSTEM: The nut drivers were designed with a unique spin-off feature which provides a fast and safe installation each time. When the face of the driver comes into contact with the material you are installing into, continue drilling until nut driver spins free. Installation is then complete. Warranty requires the use of the appropriate nut driver for installations.



SIDEWINDER® FOR STEEL

HORIZONTAL APPLICATION



Product Features

- Made with Teks® self-drilling fasteners - no pre-drilling required.
- Installs into steel range from 20 gauge – 1/2" thicknesses.
- A standard screwgun with a depth sensitive nosepiece should be used to install Teks. For optimal fastener performance, the screwgun should be a minimum of 6 amps and have an RPM range of 0-2500.
- Saves time from traditional methods.
- Reduces installation costs.
- Quick to install using the Sammys Nut Driver with an 18V cordless drill/driver.
- Manufactured in the U.S.A.

Watch a video demonstration at www.itwbuildex.com

Application



| Bit | Approvals | Rod Size | Part # | Model | Screw Descriptions | Ultimate Pullout (lbs) | UL Test Load (lbs) | FM Test Load (lbs) | Min Thick | Max Thick | Box Qty | Case Qty |
|-------|-----------|----------|---------|--------------|-------------------------|------------------------|--------------------|--------------------|-------------|-----------|---------|----------|
| - | | 1/4" | 8047957 | SWD 100 | 1/4-14 x 1" TEKS 3 | 1477 (16 ga.) | - | - | .060"-16 ga | 3/16" | 25 | 125 |
| - | | 1/4" | 8049957 | SWDR 100 * | 1/4-20 x 1" TEKS 3 | 1900 (20 ga.) | - | - | .036"-20 ga | 3/16" | 25 | 125 |
| - | | 3/8" | 8050957 | SWD 10 | 1/4-14 x 1" TEKS 3 | 1477 (16 ga.) | - | - | .060"-16 ga | 3/16" | 25 | 125 |
| - | | 3/8" | 8080925 | SWD 10-SS | 1/4-14 x 1" TEKS 3 | 1477 (16 ga.) | - | - | .060"-16 ga | 3/16" | 25 | 125 |
| - | | 3/8" | 8052957 | SWD 20 | 1/4-14 x 2" TEKS 3 | 1477 (16 ga.) | - | - | .060"-16 ga | 3/16" | 25 | 125 |
| - | | 3/8" | 8055957 | SWDR 1 * | 1/4-20 x 1" TEKS 3 | 1900 (20 ga.) | 1500 | 1475 | .036"-20 ga | 3/16" | 25 | 125 |
| UL FM | | 3/8" | 8054957 | SWDR 1-1/2 * | 12-24 x 1-1/2" TEKS 5 | 2375 (3/16") | 1500 | 1475 | .188"-3/16" | 1/2" | 25 | 125 |
| UL FM | | 3/8" | 8056957 | SWDR 516 * | 5/16-18 x 1-1/4" TEKS 3 | 2480 (20 ga.) | 1500 | 1475 | .036"-20 ga | 3/16" | 25 | 125 |
| UL FM | | 3/8" | 8057957 | SWT 15 | 12-24 x 1-1/4" TEKS 5 | 2375 (3/16") | - | - | .188"-3/16" | 1/2" | 25 | 125 |

*Includes retaining nut

SAMMYS SWIVEL HEAD™ FOR STEEL

SWIVEL APPLICATION



Product Features

- Eliminates distortion of threaded rod in sloped roof applications.
- Accommodates 3-1/2 x 12 pitch.
- Installs into angled z-purlin; allows threaded rod to hang plumb.
- Allows 17° deflection from vertical.
- Manufactured in the U.S.A.

Watch a video demonstration at www.itwbuildex.com

Application



| Bit | Approvals | Rod | Part # | Model | Screw Descriptions | Ultimate Pullout | UL Test | FM Test | Min Thick | Max | Box | Case |
|-------|-----------|------|---------|------------|-----------------------|------------------------------|---|--------------|-----------|-------|-----|------|
| UL FM | | 3/8" | 8137957 | SH-DSTR 1* | 1/4-20 x 1" TEKS 3 | 3220 (3/16") | 1500 | 1475 | .035" | 3/16" | 25 | 125 |
| UL | | 3/8" | 8268957 | SH-TEK 50 | 12-24 x 1-3/4" TEKS 5 | 2368 1306 2281 1585 | 1500 (Vertical) 850 (45° off vertical) | 4" 2-1/2" | 3/16" | 1/2" | 25 | 125 |
| - | | 1/2" | 8270957 | SH-TEK 5.0 | 12-24 x 1-3/4" TEKS 5 | 2368 1306 2281 1585 | - | - | 3/16" | 1/2" | 25 | 125 |

*Does not comply with ROHS requirements / Includes retaining nut

SAMMY X-PRESS®

VERTICAL APPLICATION



Product Features

- The Sammy X-Press expands to provide direct vertical attachment in:
 - light gauge steel deck or purlin (22 ga. - 1/8").
- Installs in seconds with Sammy X-Press It Tool, saving time & installation costs.
- Use in applications where access to the back of the installed fastener is prohibited. ie. metal roof deck, tubular steel, or vapor barrier fabric.
- Less jobsite material needed.
- No retaining nut required.
- Provides design flexibility.
- Manufactured in the U.S.A.

Watch a video demonstration at www.itwbuildex.com

Application

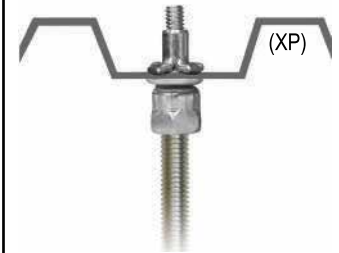

| Approvals | Rod Size | Part # | Model | Descriptions | Ultimate Pullout (lbs) | UL Test Load (lbs) | UL Min Thick | FM Test Load (lbs) | FM Min Thick | Max Thick | Application |
|-----------|----------|---------|--------|-------------------|------------------------|---|----------------------------------|---|----------------|-----------|---|
| UL | 1/4" | 8181922 | XP 200 | Sammy X-Press 200 | 1146 (22 ga) | 185 (Luminaire) 250 (Luminaire) | .027" .056" | - | - | .125" | Metal Deck |
| UL FM | 3/8" | 8150922 | XP 20 | Sammy X-Press 20 | 1146 (22 ga) | 850 (2½" Pipe) 185 (Luminaire) 250 (Luminaire) 283 (Conduit & Cable) | .027" .027" .056" .029" | 940 (2" Pipe) 1475 (4" Pipe) | .029" .104" | .125" | Metal Deck |
| UL FM | 3/8" | 8153922 | XP 35 | Sammy X-Press 35 | 1783 (16 ga) | 1500 (4" Pipe) 185 (Luminaire) 250 (Luminaire) 416 (Conduit & Cable) | .060" .029" .056" .059" | 940 (2" Pipe) 1475 (4" Pipe) | .029" .104" | .125" | Purlin |
| UL | 3/8" | 8150922 | XP 20 | Sammy X-Press 20 | 1146 (22 ga) | 850 (2½" Pipe) | | Pre-Pour Structural Concrete at 3000 psi Post-Pour Range II LWC ≤ 35 PCF (lbs/ft³) | | | Metal Deck PRE-POUR Metal Deck POST-POUR |



SAMMY X-PRESS SIDEWINDER™

HORIZONTAL APPLICATION



Product Features

- The Sammy X-Press Sidewinder expands to provide horizontal attachment in:
 - 16ga - 3/16" steel - purlin, tubular steel.
- Installs in seconds with Sammy X-Press It Tool, saving time & installation costs.
- Use in applications where access to the back of the installed fastener is prohibited. ie. metal roof deck, tubular steel, or vapor barrier fabric.
- Less jobsite material needed.
- No retaining nut required.
- Provides design flexibility.
- Manufactured in the U.S.A.

Watch a video demonstration at www.itwbuildex.com

Application



| Approvals | Rod Size | Part # | Model | Descriptions | Ultimate Pullout (lbs) | UL Test Load (lbs) | UL Min Thick | Max Thick | Box Qty | Case Qty | Application |
|-----------|----------|---------|---------|------------------|------------------------|--|--------------|-----------|---------|----------|-------------|
| UL | 3/8" | 8293957 | SWXP 35 | Sammy X-Press 35 | 1798 (16 ga) | 1250 (3½" Pipe) 80 (Luminaire) 416 (Conduit & Cable) | .059" | .125" | 25 | 125 | Purlin |

SAMMY X-PRESS SWIVEL™

SWIVEL APPLICATION



Product Features

- The Sammy X-Press Sidewinder expands to provide horizontal attachment in:
 - 89° in z-purlin
 - 45° in metal deck for 12/12 pitch
- Installs in seconds with Sammy X-Press It Tool, saving time & installation costs.
- Use in applications where access to the back of the installed fastener is prohibited. i.e. metal roof deck, tubular steel, or vapor barrier fabric.
- Less jobsite material needed
- No retaining nut required.
- Provides design flexibility.
- Manufactured in the U.S.A.

Watch a video demonstration at www.itwbuildex.com

Application



| Approvals | Rod Size | Part # | Model | Descriptions | Ultimate Pullout (lbs) | UL Test Load(lbs) | UL Min Thick | FM Test Load (lbs) | FM Min Thick | Max Thick | Application |
|-----------|----------|---------|---------|---------------------------|--|---|--------------|--------------------|--------------|-----------|-------------|
| UL FM | 3/8" | 8294922 | SXP 20 | Swivel X-Press 20 | 1061 (22 ga Vert) 829 (45° Off Vert) | 750 (2" Pipe) | .029" | 635 (2" Pipe) | .029" | .125" | Metal Deck |
| | | | | | | 170 Vertical (Luminaire) 80 at 45° (Luminaire) 283 Vertical (Conduit & Cable) 233 at 45° (Conduit & Cable) | | | | | |
| UL FM | 3/8" | 8295922 | SXP 35 | Swivel X-Press 35 | 1675 (16 ga Vert) 1558 (89° Off Vert) | 1250 (3½" Pipe) | .059" | 635 (2" Pipe) | .029" | .125" | Purlin |
| | | | | | | 250 Vertical (Luminaire) 80 at 90° (Luminaire) 500 Vertical (Conduit & Cable) 333 at 89° (Conduit & Cable) | | | | | |
| - | 1/2" | 8272957 | SXP 2.0 | Swivel X-Press 2.0 | 1061 (22 ga Vert) 829 (45° Off Vert) | - | - | - | - | - | Metal Deck |
| - | 1/2" | 8271957 | SXP 3.5 | Swivel X-Press 3.5 | 1675 (16 ga Vert) 1558 (89° Off Vert) | - | - | - | - | - | Purlin |

SAMMY X-PRESS IT®

INSTALLATION TOOL



Product Features

- The Sammy X-Press expands to provide direct vertical attachment in:
 - metal deck (22-16 gauge)
 - z-purlin (18-16 gauge)
- Manufactured in the U.S.A.

Watch a video demonstration at www.itwbuildex.com

Application



| Part # | Model | Description | Qty |
|---------|--------|------------------------|-----|
| 8194910 | UXPIT* | Universal X-Press Tool | 1 |
| 8152910 | XPDB | 25/64" Drill Bit | 1 |

*Tool Includes: Sleeve, Bit Receiver, Hex Wrench, and 25/64" Drill Bit

SAMMYS® FOR CONCRETE

VERTICAL APPLICATION



Product Features

- Easy two step process (Drill hole & drive Sammys concrete anchor).
- 1/4" pre-drilled pilot hole required.
- Concrete Installation Tool available for a one tool installation process.
- Manufactured in the U.S.A.
- **New Sammys for Cracked Concrete now available!**

Watch a video demonstration at www.itwbuildex.com

Application

Metal Deck

| Bit | Approvals | Rod Size | Part # | Model | Screw Descriptions | Ultimate Pullout (lbs) | FM Test Load (lbs) | Box Qty | Case Qty |
|-----|--------------|----------|---------|-----------|--------------------|------------------------|--------------------|---------|----------|
| | - | 1/4" | 8058957 | CST 200 | 5/16 x 1-3/4" | 2400 | - | 25 | 125 |
| | FM | 3/8" | 8059957 | CST 20 | 5/16 x 1-3/4" | 2400 | 1475 | 25 | 125 |
| | - | 3/8" | 8145925 | CST 20-SS | 5/16 x 1-3/4" | 2400 | - | 25 | 125 |
| | - | 1/2" | 8060925 | CST 2 | 5/16 x 1-3/4" | 2400 | - | 25 | 125 |
| | ICC-ESR 2202 | 3/8" | 8306957 | CCST 516 | 5/16-14 x 2-1/2" | 857** | - | 25 | 125 |

For complete performance data see ICC Report ESR-2202

* Tested in 3000 PSI concrete ** Pullout strength for Cracked Concrete and Seismic Zones A-F

SIDEWINDER® FOR CONCRETE

HORIZONTAL APPLICATION



Product Features

- Easy two step process (Drill hole & drive Sammys concrete anchor).
- 1/4" pre-drilled pilot hole required.
- Concrete Installation Tool available for a one tool installation process.
- Manufactured in the U.S.A.
- **New Sammys for Cracked Concrete now available!**

Watch a video demonstration at www.itwbuildex.com

Application

Watch a video demonstration at www.itwbuildex.com

| Bit | Approvals | Rod Size | Part # | Model | Screw Descriptions | Ultimate Pullout (lbs) | FM Test Load (lbs) | Box Qty | Case Qty |
|-----|-----------|----------|---------|-------------|--------------------|------------------------|--------------------|---------|----------|
| | FM | 3/8" | 8061957 | SWC 20 | 5/16 x 1-3/4" | 2450 | 1475 | 25 | 125 |
| | FM | 3/8" | 8307957 | SW-CCST 516 | 5/16-14 x 2-1/2" | 857** | - | 25 | 125 |

* Tested in 3000 PSI concrete ** Pullout strength for Cracked Concrete and Seismic Zones A-F

877.941.7800 | everflowsupplies.com

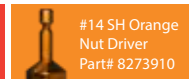
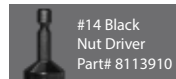

Nut Driver Key*

SPECIAL NUT DRIVER SYSTEM: The nut drivers were designed with a unique spin-off feature which provides a fast and safe installation each time. When the face of the driver comes into contact with the material you are installing into, continue drilling until nut driver spins free. Installation is then complete. Warranty requires the use of the appropriate nut driver for installations.



SAMMYS SWIVEL HEAD™ FOR CONCRETE

SWIVEL APPLICATION



Product Features

- Installs vertically and swivels up to 89° in wood & concrete structures.
- Eliminates distortion of threaded rod.
- 1/4" pre-drilled pilot hole required.
- Concrete installation tool available for a one piece installation process.
- Manufactured in the U.S.A.
- **New Sammys for Cracked Concrete now available!**

Application

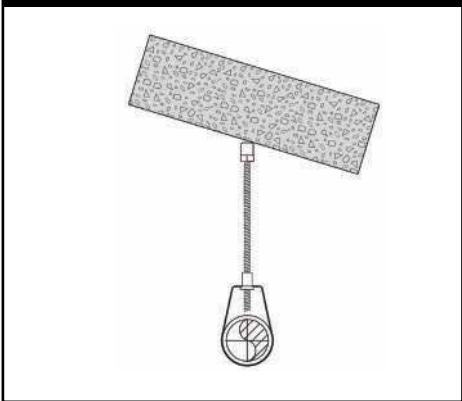

| Bit | Approvals | Rod Size | Part # | Model | Screw Descriptions | Ultimate Pullout (lbs) | Box Qty | Case Qty |
|-----|-----------|----------|---------|----------------|--------------------|--|---------|----------|
| - | | 3/8" | 8269957 | SH-GST/CST 20 | 5/16 x 1-3/4" | 2537 in 3000 psi concrete 1459 at 45° off vertical in 3000 psi concrete 2852 in 6000 psi concrete 1636 at 45° off vertical in 6000 psi concrete | 25 | 125 |
| - | | 1/2" | 8303957 | SH-GST/CST 2.0 | 5/16 x 1-3/4" | 2537 in 3000 psi concrete 1459 at 45° off vertical in 3000 psi concrete 2852 in 6000 psi concrete 1636 at 45° off vertical in 6000 psi concrete | 25 | 125 |
| - | | 3/8" | 8308957 | SH-CCST 516 | 5/16-14 x 2-1/2" | 857** | 25 | 125 |

Note: UL Listed for wood - see page 5

* Tested in 3000 PSI concrete ** Pullout strength for Cracked Concrete and Seismic Zones A-F

CONCRETE / WOOD

INSTALLATION KIT



Application

Rotary Hammer Drill into concrete

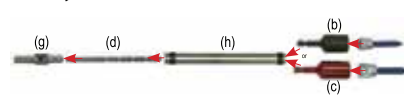

Hammer Drill into concrete

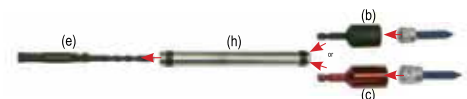

| Part # | Description | Each Qty |
|---------|-------------------------------|----------|
| 8122910 | Concrete Installation Kit (a) | - |

| Kit includes the following items: | | |
|-----------------------------------|---------------------------------|---|
| 8113910 | #14 Black Nut Driver (b) | 1 |
| 8114910 | #14 SW Red Nut Driver (c) | 1 |
| 8116910 | #250 Bit (1/4") (d) | 1 |
| 8117910 | SDS Bit (1/4") (e) | 1 |
| 8118910 | 7/32 Wood Bit (f) | 1 |
| 8120910 | HEX 250 Bit Receiver (1/4") (g) | 1 |
| 8098910 | SL 250 Sleeve (h) | 1 |

*Only sold separately - not included in kit.

| | | |
|---------|------------------------|---|
| 8121910 | SDS B250 Bit Receiver* | 1 |
|---------|------------------------|---|

SAMMYS TOGGLE™



Installation Steps

1. Pre-drill a 5/8" hole with a regular drill or hole saw.
2. Insert SST screw into #14 black nut driver. With wing nut and washer on bolt, insert wing nut through surface, and begin installation.
3. When bolt is secure and nut driver spins free, stop drill motor and remove.
4. SST screw is now ready to receive 1/4", 3/8", or Metric all thread rod or bolt stock.

Application

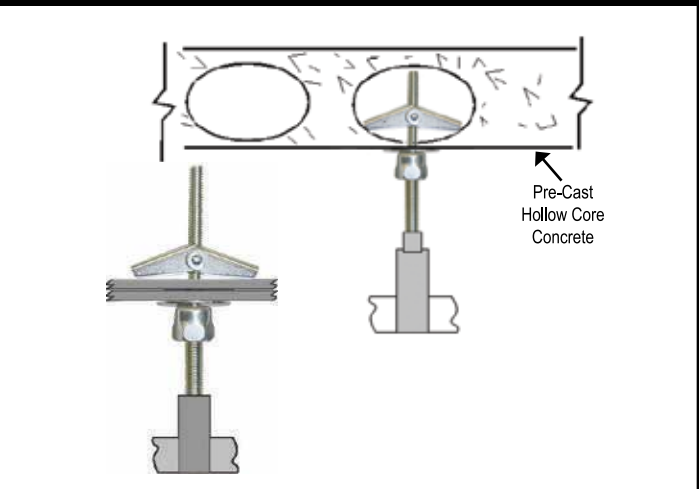

| Bit | Rod Size | Part # | Model | Screw Descriptions | Ultimate Pullout (lbs) | Box Qty | Case Qty |
|-----|----------|---------|---------|--------------------|---|---------|----------|
| | 1/4" | 8063925 | SST 300 | 1/4 x 3" | 450 (Lath & Plaster) 404 (2 Layers 5/8 Rock) | 25 | 125 |
| | 3/8" | 8064925 | SST 30 | 1/4 x 3" | 450 (Lath & Plaster) 404 (2 Layers 5/8 Rock) | 25 | 125 |

CEILING SCREWS



Product Features

- 3/16 eyelet to accommodate common wire size.
- ICC approvals can be found at www.itwbuildex.com under Evaluation Report # ER-5367

Application

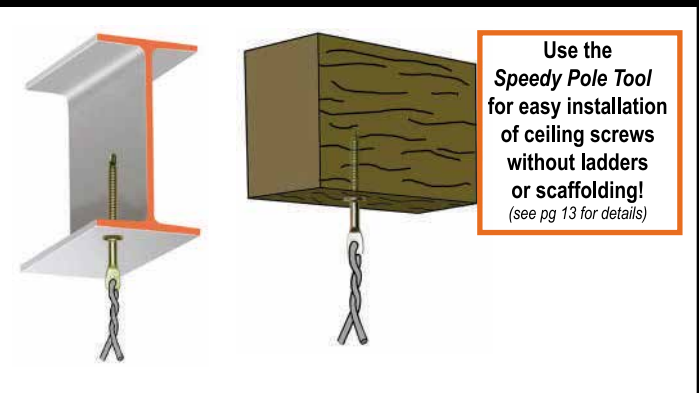

| Approvals | Substrate | Part # | Model | Point | Description | Total Length | Ultimate Pullout (lbs) | Max Gauge | ICC Test Load (lbs) | Box Qty | Case Qty |
|-----------|-------------|---------|------------------------|--------|--------------|--------------|------------------------|-----------|---------------------|---------|----------|
| ICC | STEEL | 8107957 | CWSD 1* | Teks | 1/4 x 1" | 2" | 472 (20 ga) | 16 ga. | 170 (20 ga) | 25 | 125 |
| ICC | STEEL/ WOOD | 8190957 | CWSD 15* | Gimlet | 1/4 x 1-1/2" | 2-3/4" | 472(20 ga) 980 (Fir) | 20 ga. | 270 (20 ga) | 25 | 125 |
| ICC | STEEL | 8108957 | CWSD 2* | Teks | 1/4 x 2" | 3-1/4" | 472 (20 ga) | 16 ga. | 170 (20 ga) | 25 | 125 |
| ICC | - | 8110910 | CWIT Installation Tool | - | - | - | - | - | - | - | 1 |

CWIT Installation Tool Part#8110910

*Does not comply with ROHS requirements

DEKTITE PIPE FLASHING



Product Features

- Complies with NFPA 13 Code Changes
- Flashing for dry pendant sprinklers subject to extreme temperature changes.
- Complies with NFPA 13 Code Changes

Application

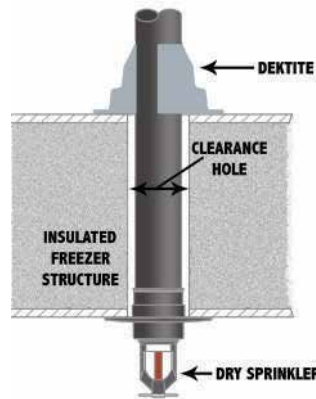

STAY UP TO CODE!
with a quicker, more efficient way to flash your refrigeration/freezer units.

| Part # | Description | Pipe Outside Diameter | Dektite Base Diameter | Dektite Height | Box Qty |
|---------|-------------|-----------------------|-----------------------|----------------|---------|
| 4001910 | Mini | 1/4" - 1-1/8" | 3-1/2" | 1-3/4" | 20 |
| 4003910 | 1 | 1/2" - 2" | 4-3/4" | 3" | 10 |
| 4004910 | 2 | 1-3/4" - 3-1/4" | 6-1/4" | 4" | 10 |

SPEEDY POLE TOOL

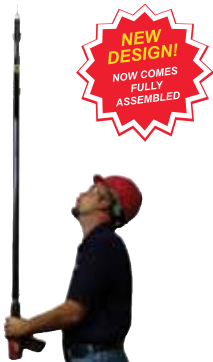

Product Features

- Speed your labor by 25%
- Work from the ground up
- No scaffolding, ladders, or lifts
- Perfect for working in tight spaces, through ceiling grid, and high vaulted ceilings
- Works with any Vertical SAMMYS: Wood, Steel, or Concrete

Installation Instructions



Adjust the Pole Tool to length. The adjusting pin must be 18" below the base or the pin may interfere with the rod.



Load rod and Sammys into Pole Tool.



The socket will spin free when the screw is completely installed. Pull down to remove the Pole Tool.

| Part # | Description | Box Qty |
|---------|----------------------------|---------|
| SP4 | Speedy Pole 4' - 12' | 1 |
| SP6 | Speedy Pole 6' - 18' | 1 |
| 8128910 | Ceiling Wire Socket Driver | 1 |

For Ceiling Wire Applications

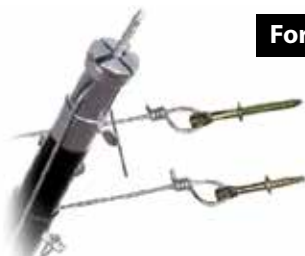

Driver hangs 12 or 9 gauge wire or jack chain



INSTALLATION INSTRUCTIONS FOR WOOD & STEEL

Installation Steps - Vertical into Wood & Steel

1. Insert the appropriate nut driver into a 3/8" or 1/2" portable drill.
2. Insert the SAMMYS® into the #14 (black) nut driver (p/n 8113910). Drill should be in a vertical position.
3. Push the face of the nut driver tight to the member. Begin installation when the nut driver spins freely on the SAMMYS, stop drill and remove.
4. The SAMMYS is now ready to receive 1/4", 3/8", 1/2" or metric all thread rod, bolt stock. (The 1/2" requires the #14SW red nut driver)

Note: When installing DSTR, follow the above instructions, then add retainer nut and torque to 20 foot lbs. for maximum pullout in purlin steel.

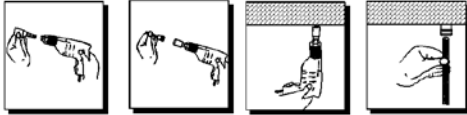

Installation Steps - Horizontal into Wood & Steel

1. Insert the appropriate nut driver into a 3/8" or 1/2" portable drill.
2. Insert the SAMMYS into the #14SW (red) nut driver (p/n 8114910). With drill unit in a horizontal position and at a right angle to the structural member, begin installation.
3. When the nut driver spins freely on the SAMMYS, stop the drill and remove.
4. The unit is now ready to receive 1/4", 3/8", M10, M8 or metric all thread rod or bolt stock.

Note: When installing SWDR, follow the above instructions, then add retainer nut and torque to 20 foot lbs. for maximum pullout in purlin steel.

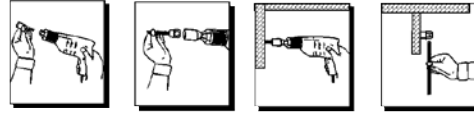

INSTALLATION INSTRUCTIONS FOR CONCRETE

Installation Steps - Vertical into Concrete

1. Using an SDS 250 carbide tip bit or a HEX RECEIVER with a #250 carbide tip bit, pre-drill the concrete member to a depth of 2" with a hammer/rotary hammer drill set on impact mode.
2. After pre-drilling has been completed, install the SLEEVE TOOL over the bit (the bit should remain in the drill), and insert the #14 (black) nut driver (p/n 8113910) into the opposite end (see Vertical Installation note above).
3. Insert the CST screw into the nut driver.
4. Place tip of screw into the pre-drilled hole, turn impact/drill unit to drill mode and begin insertion. When the nut driver spins freely on the CST screw, installation is complete. Stop and remove drill.
5. The concrete screw is ready to receive 1/4", 3/8", 1/2", or metric all thread rod or bolt stock. (#14SW red nut driver used with 1/2" screw)

Note: Use a 1200 maximum RPM drill for installation.

Note: Do not install concrete screws while the drill unit is in impact mode — doing so will destroy the pullout factor of the screw.



Installation Steps - Horizontal into Concrete

1. Using an SDS 250 carbide tip bit or a HEX RECEIVER with a #250 carbide tip bit, pre-drill the concrete member to a depth of 2" with a hammer/rotary hammer drill set on impact mode.
2. After pre-drilling has been completed, install the SLEEVE TOOL over the bit (the bit should remain in the drill), and insert the #14SW (red) nut driver (p/n 8114910) into the opposite end.
3. Insert the SWC screw into the nut driver.
4. Place tip of screw into the pre-drilled hole, turn impact/drill unit to drill mode and begin insertion. When the nut driver spins free on the SWC screw, installation is complete. Stop and remove drill.
5. The SWC screw is ready to receive 1/4", 3/8" or metric all thread rod or bolt stock.

Note: Use a 1200 maximum RPM drill for installation.

Note: Do not install concrete screws while the drill unit is in impact mode — doing so will destroy the pullout factor of the fastener

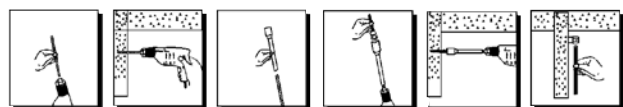

SPECIAL NOTES

Engineering Note

In 1996, the anchors listed by UL were tested in plate steel that measured .188" and .118". Subsequent testing was done for z-purlin applications in May 1997 using (.037") or 20 gauge steel. Most recently in 2008, testing with the new Sammy X-Press® was completed using (.030") or 22 gauge steel metal deck.

Sammys Nut Drivers

Special nut drivers were designed to be used with Sammys. When the appropriate nut drivers are used for installation, the driver spins freely on the screw after installation is complete and eliminates the expected wrist snap, reduces over-torque, and prevents screw failure.

Steel Screws

Due to variations in hardness of certain metals, it should be noted that our self-drilling screws for steel will experience different drill speeds. 500-1500 RPM drill speed should be used.

Metric Products

Metric versions of the Sammy anchors are available at www.itwbuildex.com

Sammys for Seismic

Please visit www.itwbuildex.com for our current Seismic product offering.

Vibratory Environments

For attaching or anchoring in high vibratory environments, special care should be taken not just for building attachments but also for the hangers or assemblies being supported. Consult local code authorities for accepted anchoring devices.

Composite Joist/Truss

Truss manufacturers vary installation recommendations for composite joist. UL testing was completed to validate that Sammys and Sidewinders SWG 20 and SWG 25-380 can be installed into the top cord of a truss. Sammy GST 20 can be installed into the center of the lower cord of a composite joist. Penetration of the upright center web is permitted by some joist manufacturers. Consult truss manufacturer for recommended installation point.

Pre-Drilling may be required by joist manufacturers. If so, pre-drill pilot hole 1/8" smaller than root diameter of fastener. Consult the table below:

| Model | Root Diameter | Hole Size |
|------------|---------------|-----------|
| GST 20 | .182" | 1/8" |
| GST 25-380 | .280" | 7/32" |
| SWG 20 | .182" | 1/8" |
| SWG 25-380 | .280" | 7/32" |

To increase efficiency of the installation process, sleeve tools, bit receivers, and wood bits are available for pre-drilling.

NFPA/NEC Standards

All UL and FM testing complies with NFPA 13 and NEC standards. Check with your local (AHJ) Authority Having Jurisdiction to confirm application and usage.

UL Listings/FM Approvals

UL and FM reports are available at www.itwbuildex.com



Technical Drawings

Technical drawings are available and can be downloaded at www.itwbuildex.com in the following formats: .dwg, .dxf, and .igs.

Manufactured in the U.S.A. Products



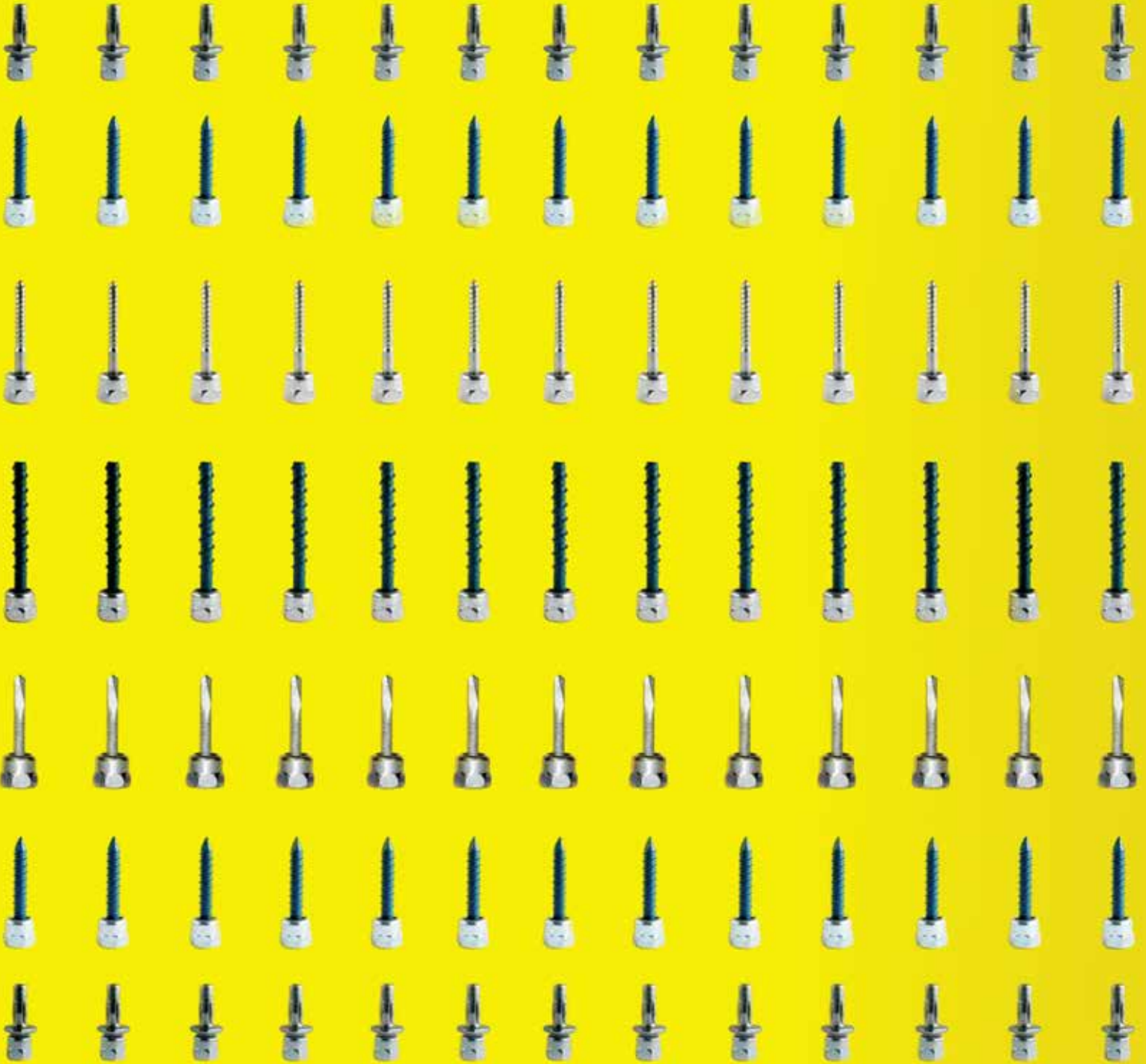

SAMMYS®  **EVERFLOW**™

#SAMMY1016



Corporate Headquarters:
100 Middlesex Avenue • Carteret, New Jersey 07008
Tel: 908.436.1100 • Fax: 908.436.1162 • Toll Free: 877.941.7800
www.everflowsupplies.com